

IDENTIFY YOUR HUB AND AXLE *INSTRUCTIONS APPLY TO ALL DRIVER CONFIGURATIONS

PIEDMONT

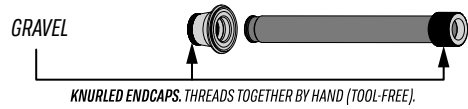

OPTIMUS, SYLVAN, GRAPPLER EN

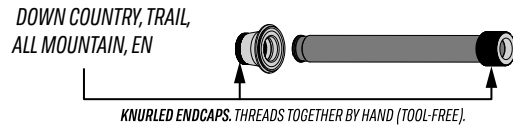

GRAPPLER DH



e*spec

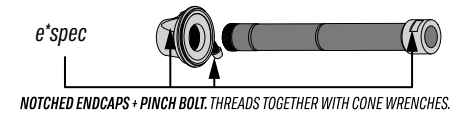

REAR HUB W/ ALUMINUM AXLE

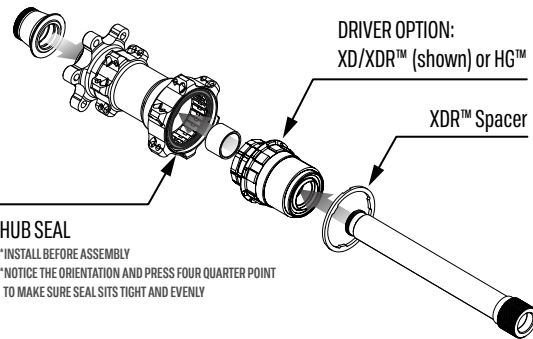

REAR HUB W/ ALUMINUM AXLE

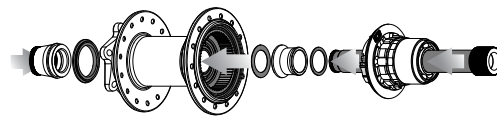

REAR HUB W/ STEEL AXLE

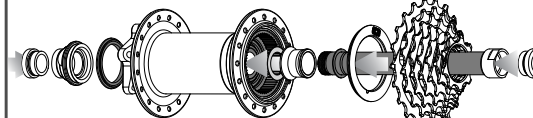

REAR HUB W/ STEEL AXLE + PINCH BOLT

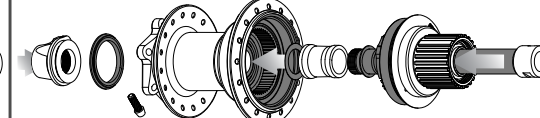

GREASE

GREASE

GREASE

SHIM + FREEHUB SPACER INSTALLATION

ALL HUBS FOUND ON OPTIMUS, SYLVAN, GRAPPLER AND E*SPEC WHEELS REQUIRED SHIM / FREEHUB SPACER ASSEMBLY AS SHOWN HERE



GREASE

*APPLY GREASE AFTER MAINTENANCE

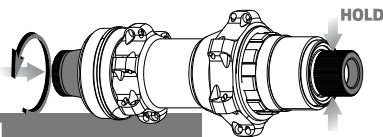

INSTALLATION
PUSH INWARD, ROTATE CLOCKWISE UNTIL ENDCAP SPINS FREELY*

*FOR REMOVAL, ROTATE COUNTER-CLOCKWISE

FRONT HUB (ALL WHEELS)

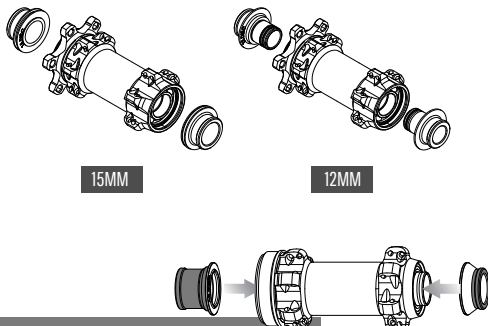

INSTALLATION

HOLD

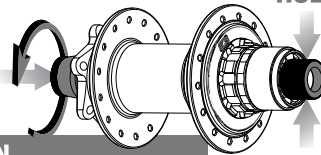

INSTALLATION
PUSH INWARD, ROTATE CLOCKWISE UNTIL ENDCAP SPINS FREELY*

*BEFORE INSTALLED ON BIKE, A SMALL AMOUNT OF SIDE-TO-SIDE PLAY IS NORMAL

HOLD

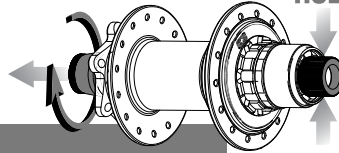

REMOVAL
PULL OUTWARD, ROTATE COUNTER-CLOCKWISE

INSTALLATION
USING CONE WRENCHES, ROTATE CLOCKWISE UNTIL SNUG, THEN ADD 90°

CONE WRENCH
DRIVE SIDE: 17MM
NON-DRIVE SIDE: 20MM*
*some older models of TRS/IGI EN use 18mm

REMOVAL
USING CONE WRENCHES, ROTATE COUNTER-CLOCKWISE

FRONT HUB (ALL WHEELS)

INSTALLATION
USING CONE WRENCHES, ROTATE CLOCKWISE UNTIL SNUG, THEN ADD 90°. TIGHTEN PINCH BOLT TO 3Nm

CONE WRENCH
DRIVE SIDE: 17MM
NON-DRIVE SIDE: 20MM*
*some older models of TRS/IGI EN use 18mm

REMOVAL
LOOSEN PINCH BOLT. USING CONE WRENCHES, ROTATE ENDCAPS COUNTER-CLOCKWISE

GREASE

INSTALLATION

REMOVAL

TUBELESS TAPE

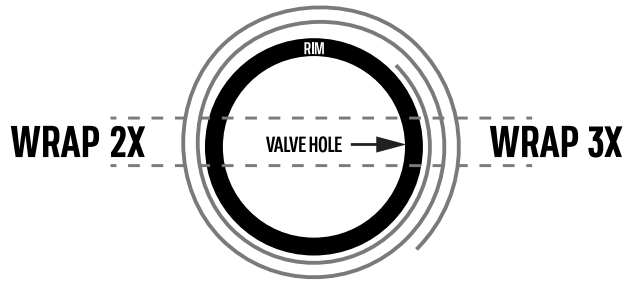

e*thirteen GEN 2 VALVE

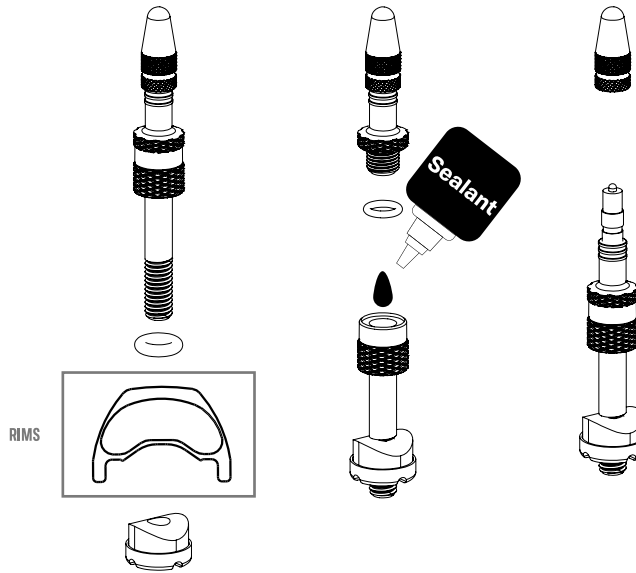

TUBELESS SEALANT + TIRE

