

8

REARHUBS CONT.

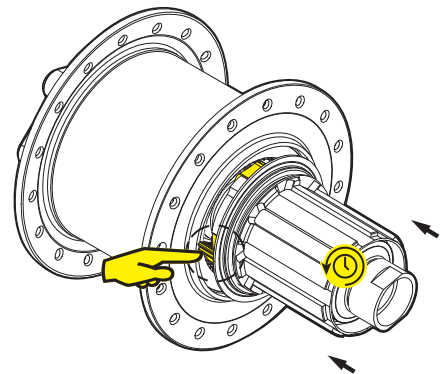

Slide the axle with the freehub spacer, freehub body and freehub shim into the bearing spacer and hub shell. Turn the freehub body counter-clockwise to depress the pawls into the hub shell. You may need to depress the pawls with a tool to get them to seat.

9

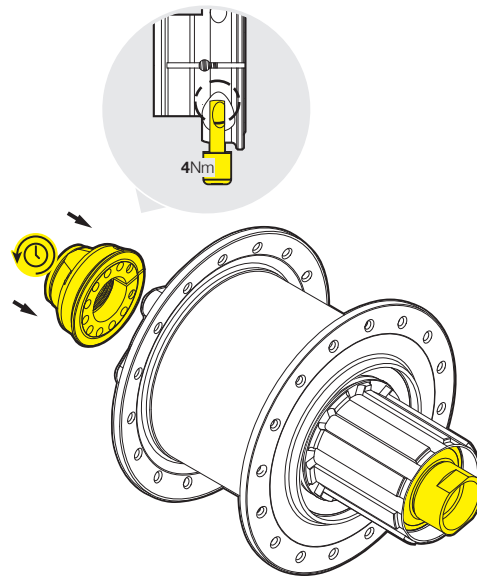

Lightly grease the threads and install the non-drive side endcap by turning counter-clockwise. Tighten the endcap using the 17 and 19mm cone wrenches until no bearing play is felt. Secure the endcap by tightening the pinch screw to 4nm. If not using a torque wrench, tighten the screw 1/4 turn, or 90°, past the screw head making contact with the endcap.

10

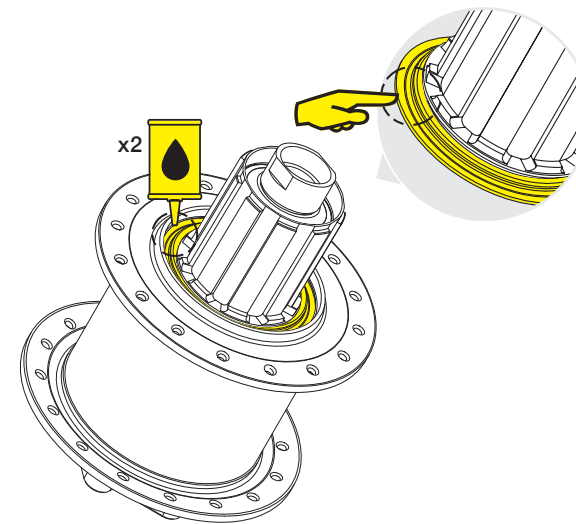

Add 2 drops of oil to the freehub seal.

11

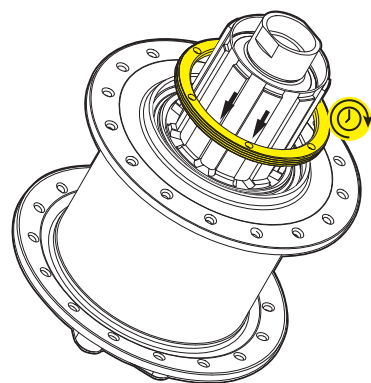

Install the locking. Tighten 1/4 turn past snug with a locking spanner\* with pin diameter of 0.09(2.3mm). \*Red handle Park Tool SPA-2C.

12

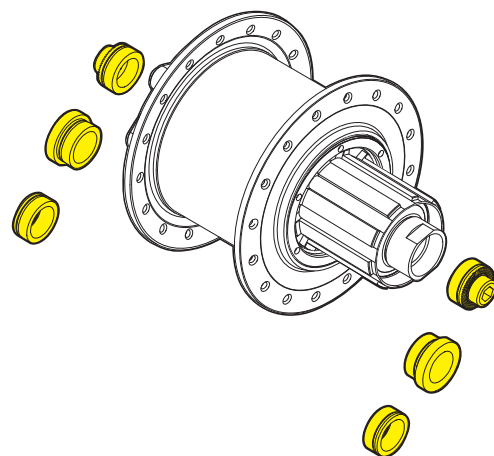

Lightly grease the endcap plugs and endcap plug O-rings. Install the plugs by pressing them into the axle and endcap.



TECHINFO

**LOCTITE**  
1) Loctite 638

**GREASE**  
1) Shimano  
2) Progold EPX

**OIL**  
1) Redline Superlight Shockproof gear oil  
2) Lightweight gear oil

**WHEELBUILDING**  
Wheel building and wheel  
FAQ visit, [service.bythehive.com](http://service.bythehive.com)

Assembly and tech videos:  
[www.service.bythehive.com](http://www.service.bythehive.com)

For more information visit, [www.service.bythehive.com](http://www.service.bythehive.com) for the most up to date technical documentation for all e\*thirteen products.



LG1 / TRS Hub Service Manual



REQUIRED TOOLS

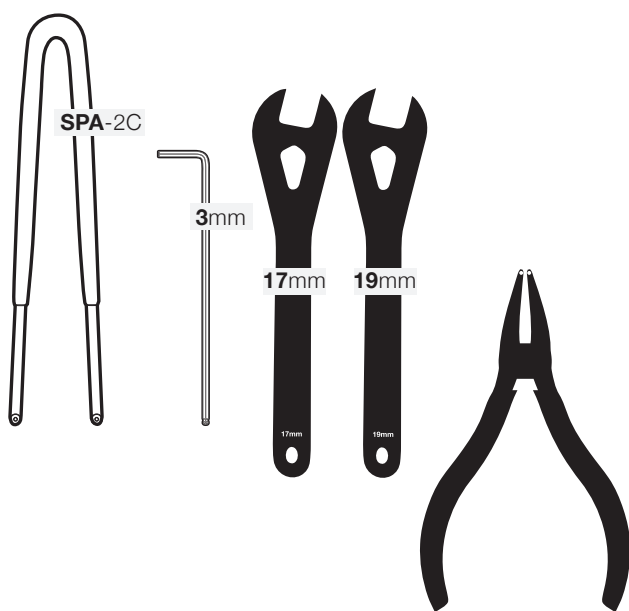

Required tools: 3mm hex wrench and locking spanner (Red handle Park Tool SPA-2C), 17mm cone wrench, 19mm cone wrench, external C-clip pliers.

1

FRONT HUBS

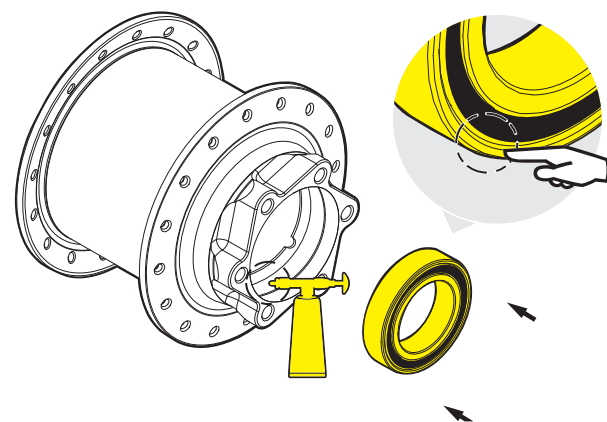

If you are unfamiliar with the bearing installation (and removal) process take your hub to your local shop for installation with the proper tools. Press disc-side bearing into hub. **Apply pressure to outer race only while installing bearings.**

2

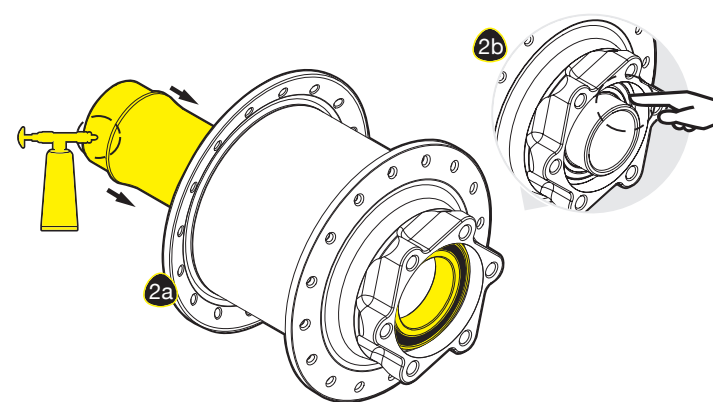

Lightly grease axle and slide through the hub into disc-side bearing (2a) making sure the flange on the axle fully contacts the inner bearing race (2b). Repeat bearing installation from step 1 and press in drive side bearing.

3

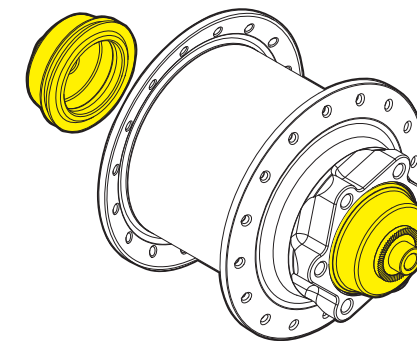

Lightly grease and press axle end caps onto axle.

\*For bearing installation tool user manual refer to the Chub hub (BYTHEHIVE) bearing service manual. [BYTHEHIVE.COM/SUPPORT](http://BYTHEHIVE.COM/SUPPORT)

4

REAR HUBS

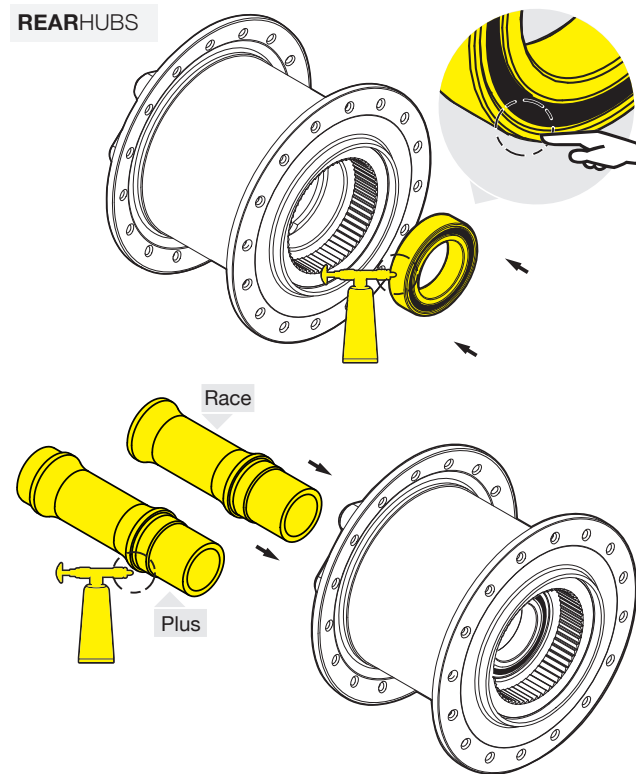

Press driveside bearing into hub body. **Apply pressure to outer race only while pressing bearings.** Lightly grease and slide the bearing spacer into the drive-side bearing.

5

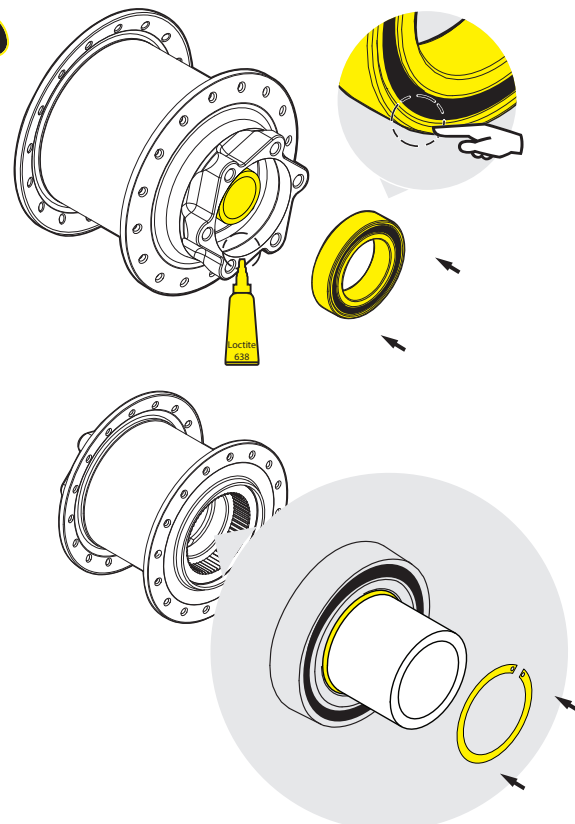

Clean bearing seat with alcohol. Apply a light coating of Loctite 638 to outer bearing race. Press in non-drive side bearing, capturing the bearing spacer. If your axle spacer uses a C-clip\*, install it into the groove on the drive side stub of the axle spacer. \*Only on 2015 hubs and later.

6

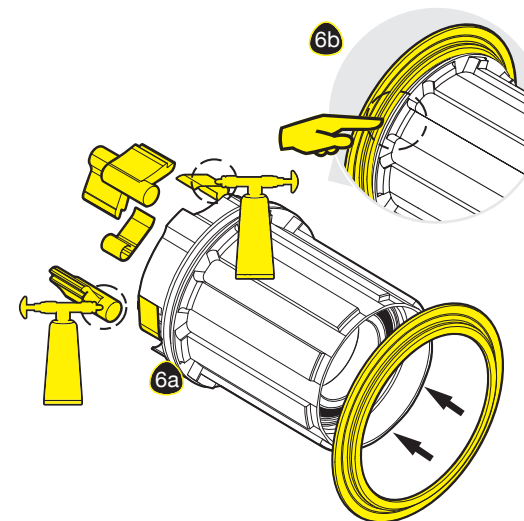

Lightly grease the freehub pawl pockets only and slide the pawls into place. (6a) check the pawl spring function by pressing on the pawls. Install the freehub dust seal into the groove on the freehub body, be sure the seal cup is facing away from the pawls (6b). Lube the pawls, ratchet ring, and seal with Redline Superlight Shockproof gear oil. **Do not fill freehub body with grease.**

7

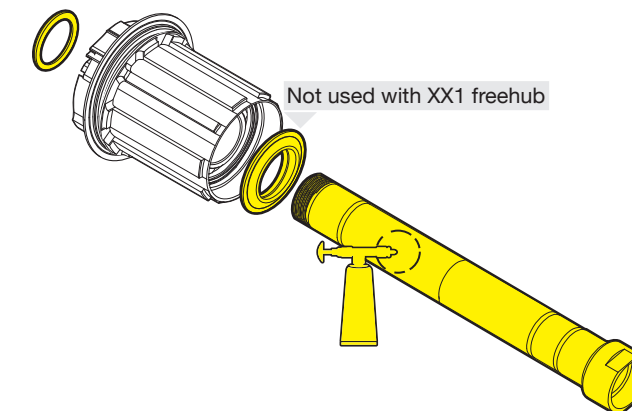

Lightly grease the axle. Slide the freehub spacer onto the axle with the beveled side against the stop on the axle. Note: this spacer is NOT used with the XX1 freehub body. Slide the freehub body onto the axle, followed by the thin freehub shim.