

**AVAILABLE PRODUCT CONFIGURATIONS**

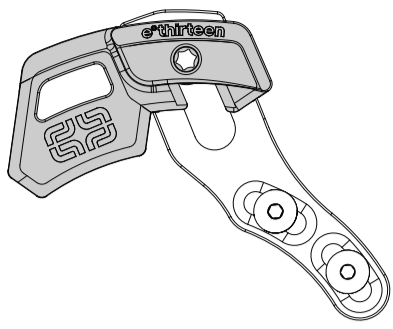

**Chainguide**

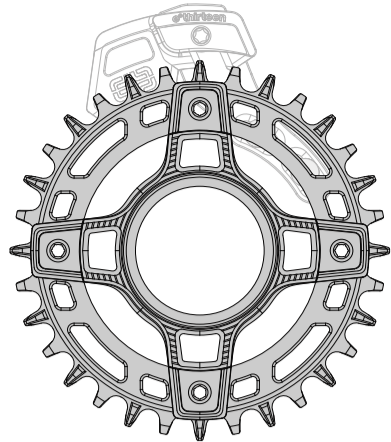

**No Bashguard**

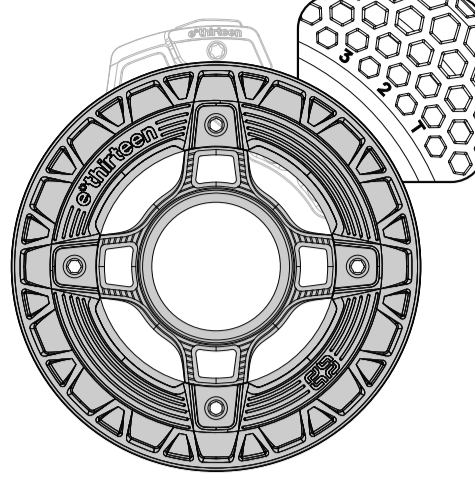

**32T Bashguard**

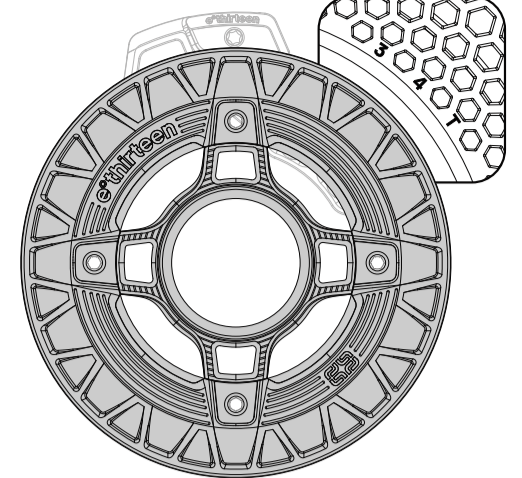

**34T Bashguard**

**CHAINGUIDE PART LIST**

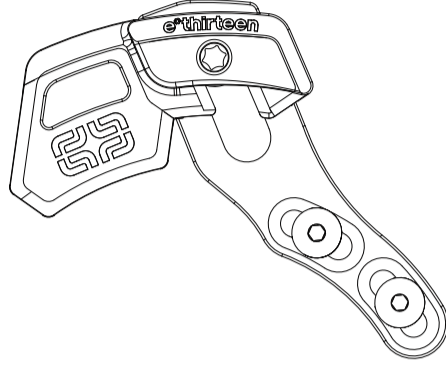

GUIDE 1PC	SLIDER BOLT 1PC	BACKPLATE 1PC	MOUNTING BOLT 2PCS	WASHERS
	<b>SLIDER NUT 1PC</b>			

**CHAINGUIDE INSTALLATION**

1. SLIDE guide onto backplate.
2. INSERT slider bolt into underside slot.
3. SCREW slider bolt into nut until there is light tension.

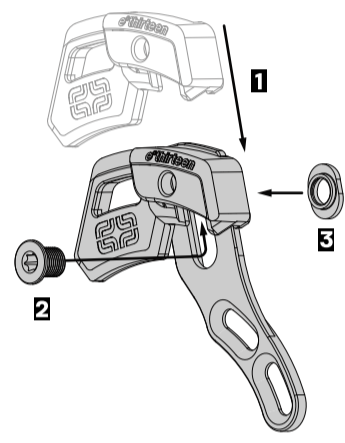

1. ADD required washers to achieve 2.5-3mm spacing to chaining wide tooth.
2. ROTATE until bolt hole aligns vertically to spindle center or until slot limit.
3. TIGHTEN mounting bolts to 6Nm.
4. SHIFT to largest cassette cog.
5. CHECK guide clearance. Reduce number of washers if needed.

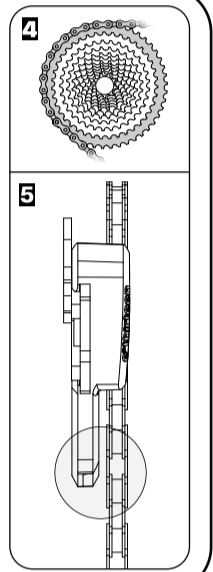
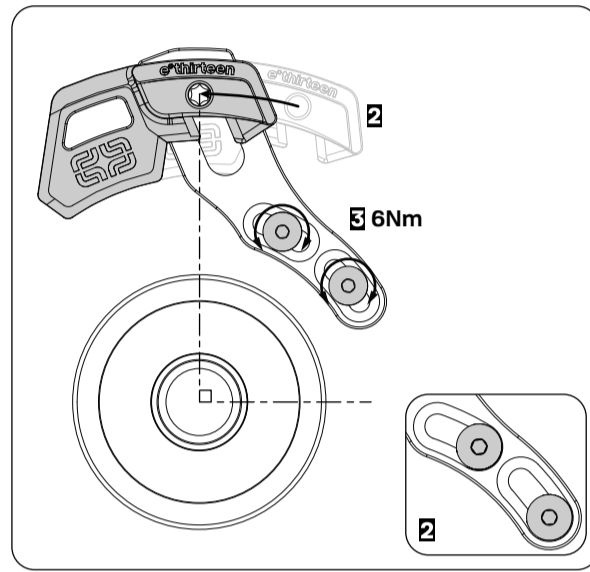
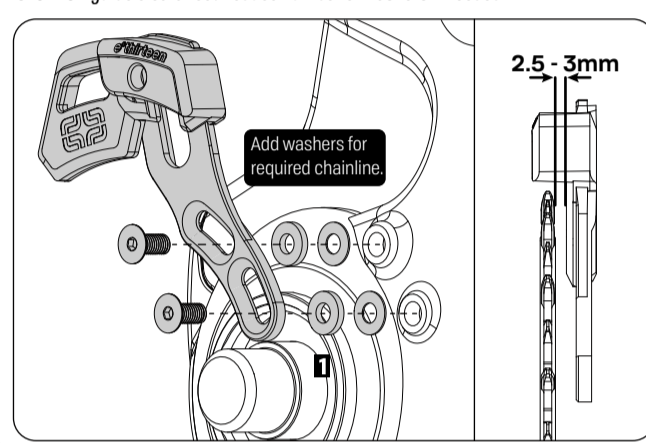

1. LOOSEN slider bolt.
2. SLIDE guide down, leaving a 3mm gap to highest chaining tooth.
3. TIGHTEN slider bolt to 1Nm.

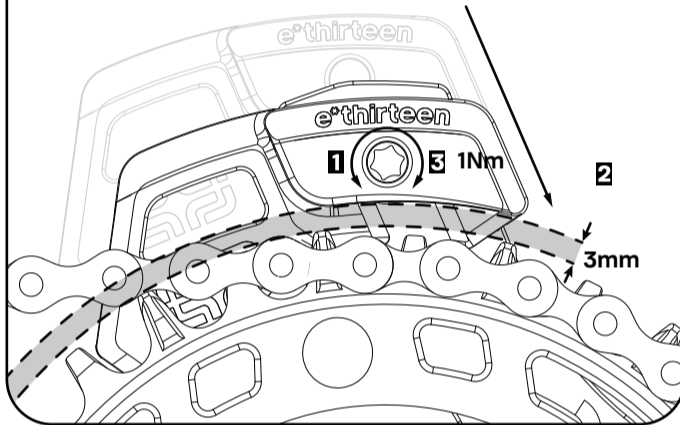

1. SHIFT chain to largest cassette cog.
2. CHECK guide-chain clearance.
3. LOOSEN mounting bolts to make clocking adjustments if:
  - There is any contact with the guide block.
  - The chain leaves the chaining at a point far beyond the end of the block.

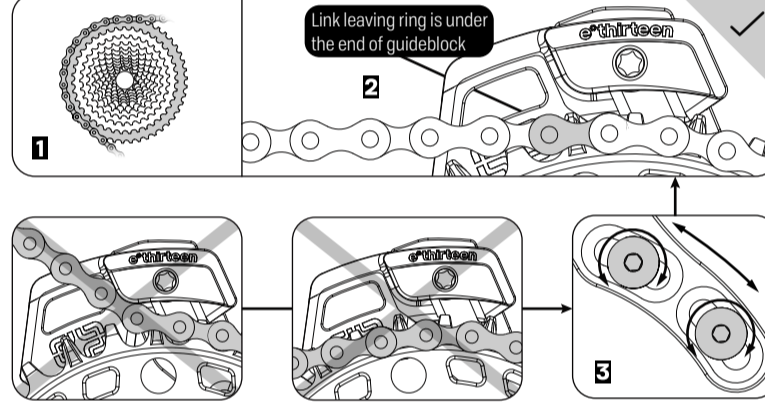

**TORQUE DIAGRAM**

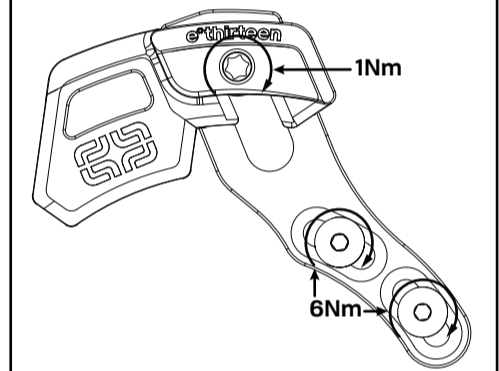

**TURBOCHARGER PART LIST**

BASHGUARD 1PC	SPACERS 4PCS	SPIDER 1PC	104BCD CHAINRING 1PC	BASHGUARD NUT 4PCS	BASHGUARD BOLT 4PCS

**TURBOCHARGER INSTALLATION**

**TURBOCHARGER INCLUDING BASHGUARD**

**TORQUE DIAGRAM**

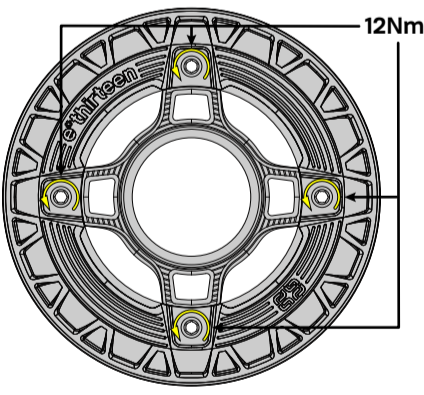

⚠ Turn bolts counterclockwise to tighten

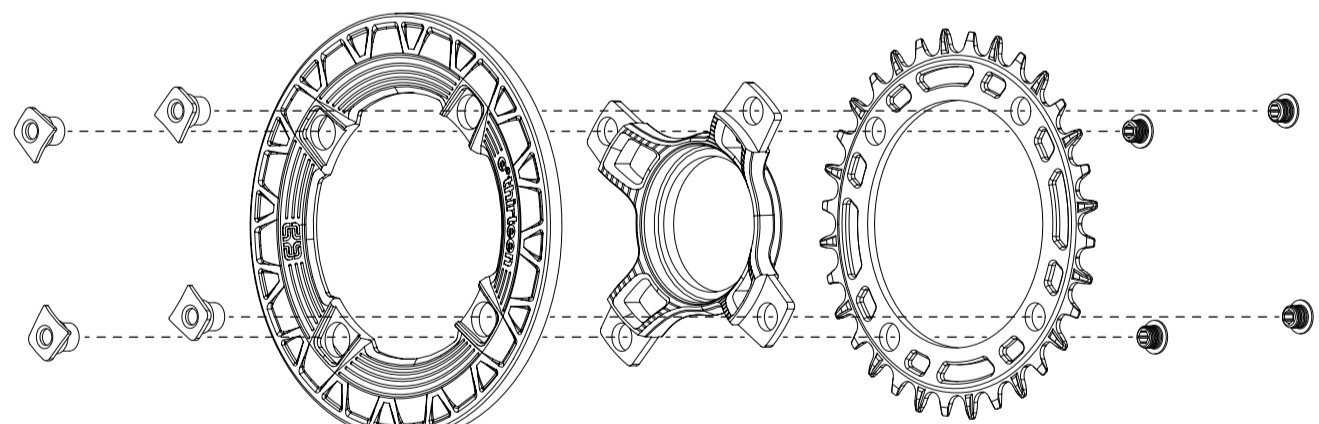

**TURBOCHARGER WITHOUT BASHGUARD**

**TORQUE DIAGRAM**

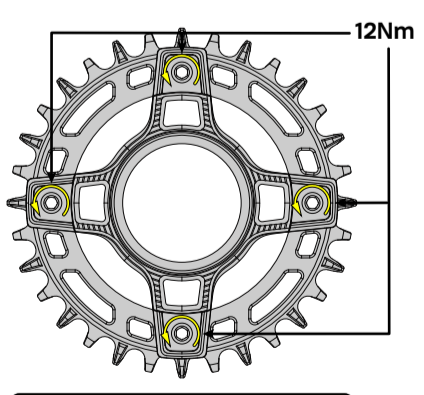

⚠ Turn bolts counterclockwise to tighten

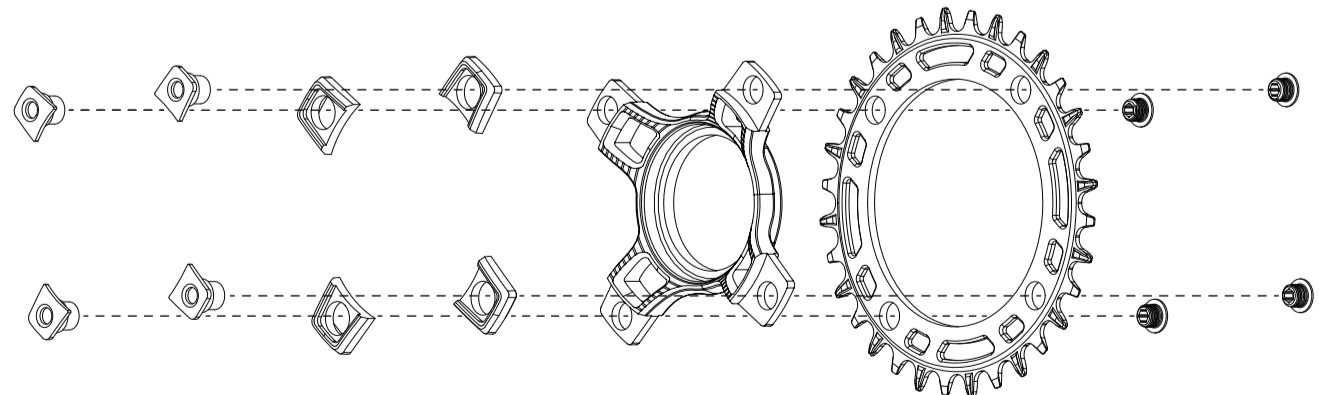

1. ASSEMBLE Turbocharger using the above diagram.
2. MOUNT Turbocharger assembly to motor interface.
3. TIGHTEN spider locker ring to torque specified by manufacturer.

