

PREPARATION & INSTALLATION

VALVE ASSEMBLY

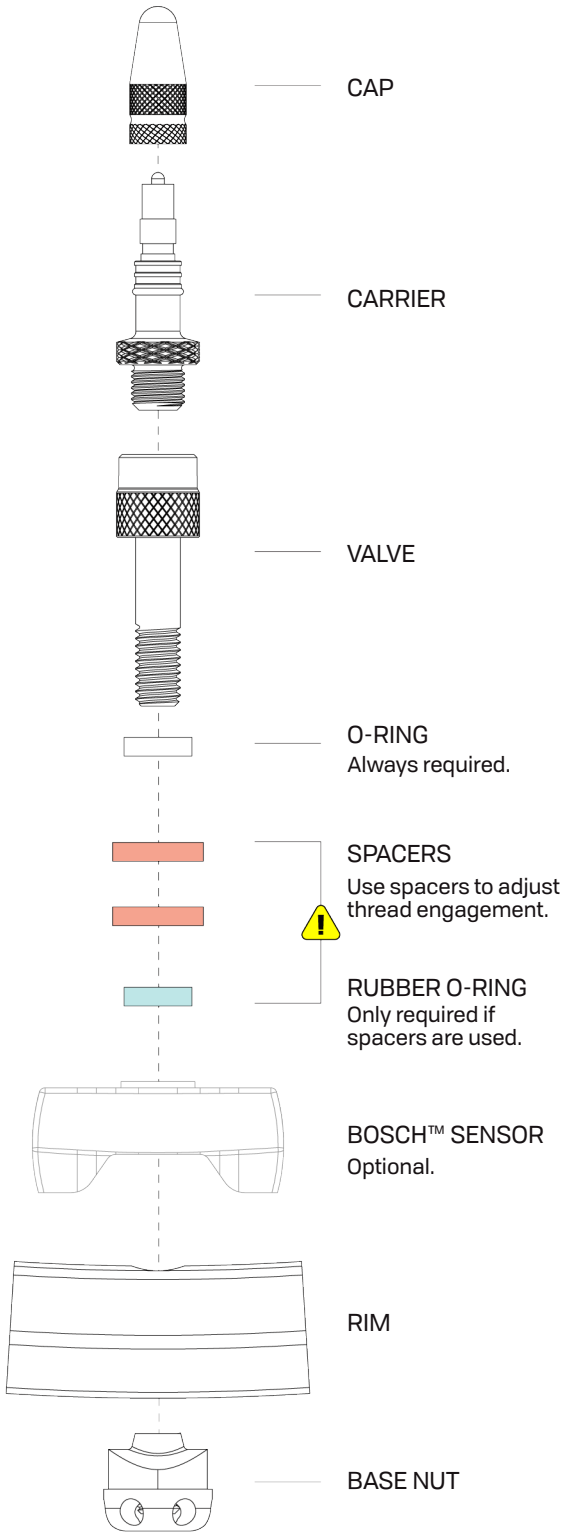

THREAD ENGAGEMENT

1. ADJUST thread engagement using spacers.

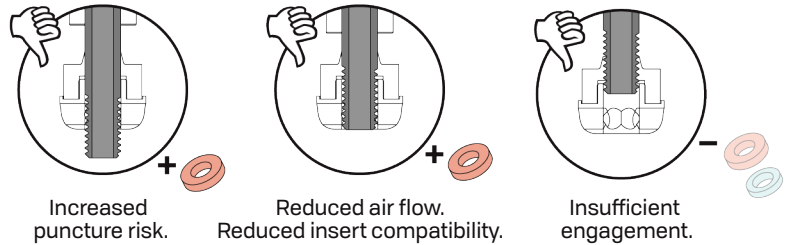
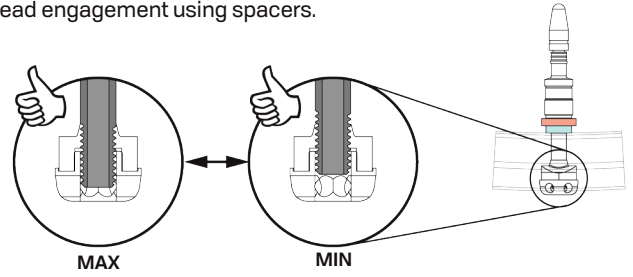

TIRE INFLATION

1. REMOVE carrier, ADD sealant.
2. INSTALL carrier, REMOVE valve cap, INFLATE tire.
3. TIGHTEN valve cap.

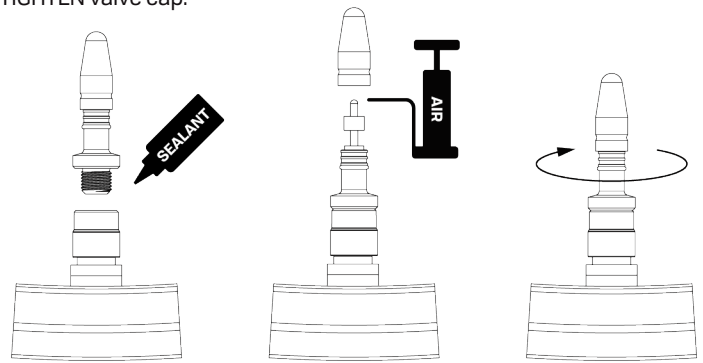

**DO NOT** remove the carrier or the valve body while the tire is inflated.

Ensure tire is completely deflated before removal

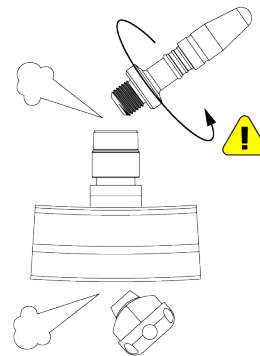

BASE NUT ORIENTATION

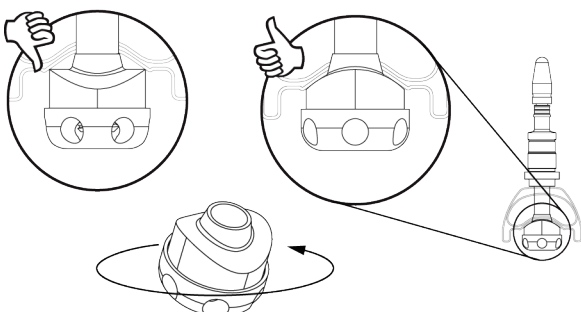

TIRE INSERT COMPATIBLE

Our base nut allows for great air flow even with tire inserts installed!

Proper spacer configuration ensures insert compatibility.

